

INSTALLATION INSTRUCTIONS

Aqua4MA
WETROOM
SYSTEMS

KUDOS

Please read these instructions throughout before installing as incorrect fitting will invalidate the guarantee

These installation instructions must be used in conjunction with the Floor4MA Waste Installation Instructions

If you are unsure about these instructions please contact Kudos Shower Products:
Customer Service Helpline: 01539 564040

TOOLS REQUIRED

- Circular saw
- Drill / Driver
- Drill bit
- Countersink bit
- Handsaw
- Craft knife
- Silicone Gun
- Spirit level
- Tape measure
- Pencil
- Silicone sealant - *neutral curing type, NOT ACETOXY TYPE*
- Tile adhesive - *cement based, flexible*
- Deep notched trowel

MATERIALS REQUIRED - not supplied

- 4" x 2" (100 x 50mm) timber
- Drywall fixing screws
- Assorted wood screws

IMPORTANT

Ensure that the product purchased is suitable for your requirements before opening the packaging.

Check appearance of the products - any defects must be reported to Kudos Shower Products before assembly / installation. Claims for imperfections will only be accepted prior to assembly / installation.

Care must be taken during installation to avoid hidden pipes, electrical cables etc.

Use only Kudos Solvent Weld where stated in these instructions. The use of any other substance will compromise the Aqua4MA system and nullify the guarantee.

GENERAL

FLOOR LEVEL

The existing floor needs to be level, however, a tolerance of 5mm per metre is acceptable and tiles need to be bedded-up to compensate for this. Anything more than 5mm per metre then the floor needs to be levelled.

TILING

Allowance must be made by the installer when tiling to compensate for any difference in levels created by:

Trimming of Top4MA and installing Height Reducers.

FIXING SCREWS

We recommend drywall screws only- *dia. 3.8/4.2mm thread* -are used to fix Top4MA and panels to floor and walls. Screw lengths are dependant upon panel thicknesses used and floorboard thickness. **Do not drill pilot holes, simply drive the screws through the Top4MA and panels.**

HANDLING TOP4MA

Care must be taken when handling/installing the Top4MA shower base as this can be damaged if not handled with due care. Please be assured once installed and fixed into place then the integral strength is re-established.

PLUMBING

All pipework must be fitted in accordance with current Building Regulations.

Pipework must be water tested throughout the installation process to ensure there are no leaks.

UNDERFLOOR HEATING

The Aqua4MA system is suitable for underfloor heating.

Aqua4MA panels are fitted to the floor then the heating system is fitted on top of the panels.

Please note that if the heating system is not required inside the showering area, ie. on top of the Top4MA base, then height allowance of the heating system and Aqua4MA panels must be taken into account to ensure a finished level surface for tiling.

TOP4MA - max. trimmable details

Some Top4MA bases can be trimmed if necessary, please see details below for maximum allowable trim.

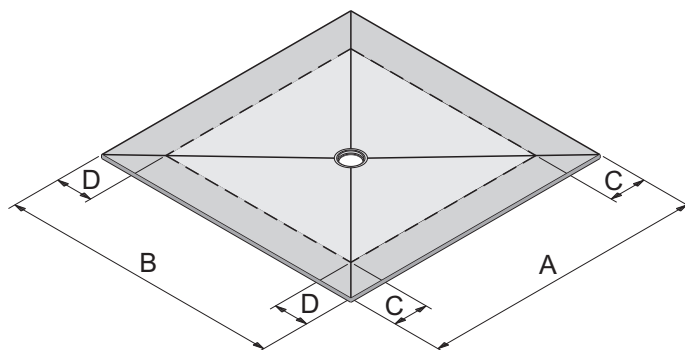

TOP4MA product	Overall size mm		Trimmable width max.	
	A	B	C	D
900 x 800	900	800	0	0
900 x 900	900	900	0	0
1200 x 800	1200	800	150	0
1200 x 900	1200	900	150	0
1200 x 1200	1200	1200	150	150
1400 x 900	1400	900	250	0
1500 x 900	1400	900	300	0
1500 x 1500	1500	1500	300	300
1700 x 900	1700	900	400	0

TILING TOP4MA

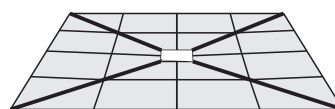

RECTANGULAR AND SQUARE
TOP4MA SHOWER BASES

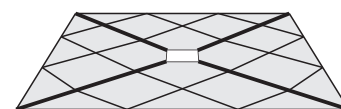

SQUARE
TOP4MA SHOWER BASES

When tiling the Top4MA, a linear tile pattern can be used for rectangular and square shaped Top4MAs. For square shaped Top4MA's a diamond pattern may be used.

For either pattern it is imperative a joint or cut in the tiles is made from the corner of the waste to the corner of the Top4MA base to maintain maximum drainage.

Small mosaic tiles will naturally follow the built-in gradient of the Top4MA base.

1

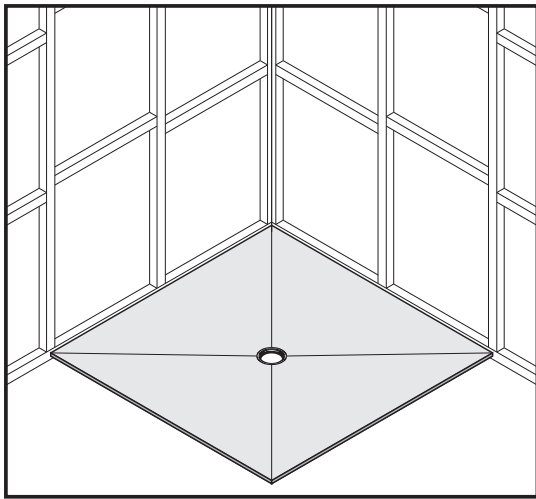

Carefully remove all packaging and **unscrew the 2 timber transit packing pieces** from the Top4MA and **discard**.

Place Top4MA base in required position against wall(s) and mark position of centre waste hole onto flooring. If your walls are not square to each other, it may be necessary to trim the **wall side(s) only**, of the Top4MA base to ensure correct fit against the walls.

If the waste hole lands on a joist or pipe-work underneath the flooring, position the Top4MA away from the wall/s to avoid these, then Aqua4MA Height adjuster panel/s can be used to infill between the wall/s and the Top4MA base.

If this is not possible the joist would need to be trimmed out properly, **ensuring that current building regulations are strictly adhered to**.

Alternatively, pipe-work would have to be re-routed.

2

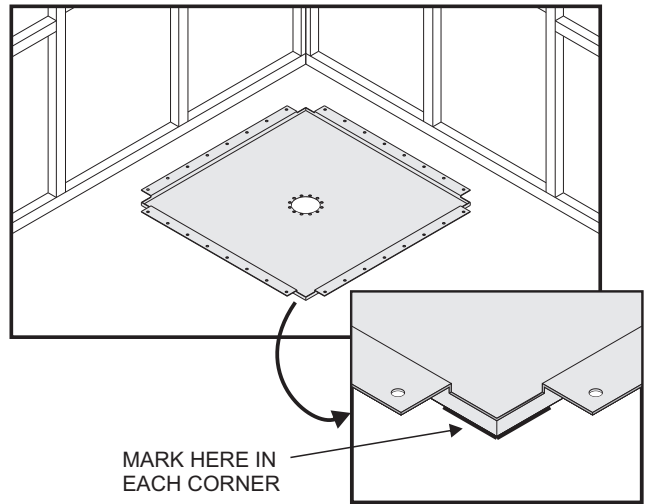

Position Metal Tray ensuring waste hole is centred over marked position. Ensuring tray is square to wall/room, mark position of tray corners onto flooring. Mark each corner as shown.

Do not mark out the outer flanged edges of the metal tray.

INSTALLING ONTO SOLID FLOOR

Follow instructions up to stage 2, then cut out concrete or screed to a minimum depth of 18mm using angle grinder.

Remove the section of concrete/screed for the waste body and waste pipe.

Solvent weld 2" waste pipe into the waste outlet. Connect the waste body to Metal tray with the 6 screws provided. Bed the Metal tray onto 'dabs' of rapid setting adhesive (*not supplied*). Floor4MA shower base and Aqua4MA panels are fixed to the solid floor using full bed of flexible tile adhesive applied with a deep notched trowel.

3

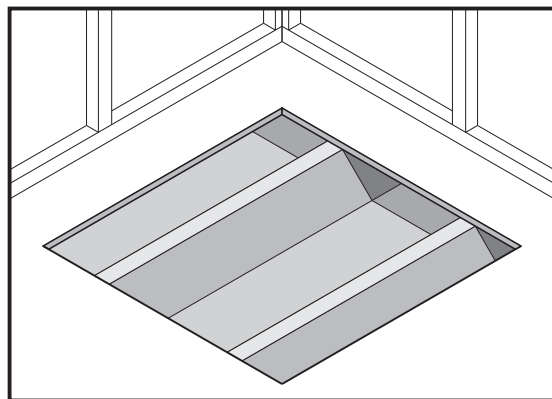

Join the marked corners and check the size - this should measure:

'900x900' Metal Tray = approx 810 x 810mm area to be removed
'900x800' Metal Tray = approx 810 x 710mm area to be removed

Using circular saw, set the depth to suit the thickness of flooring and remove the area of floorboards.

4

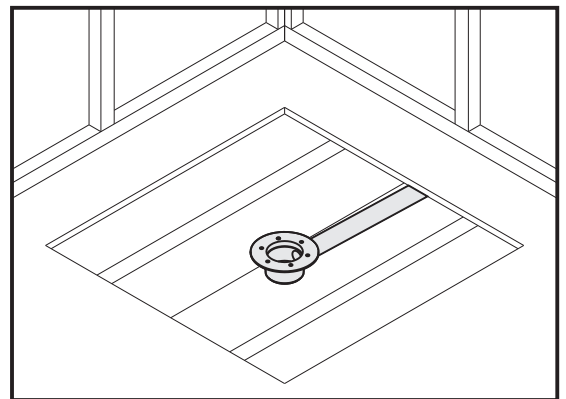

Connect waste body using 2" solvent weld waste pipe (*not supplied*), ensuring that the waste body is positioned to centre of the cut-out. Ensure that the fixing holes line up with the corresponding holes in the metal tray.

Please refer to separate instructions for details of the waste unit.

We recommend that the shower waste is connected to it's own dedicated pipework and should not be shared with other waste pipes.

5

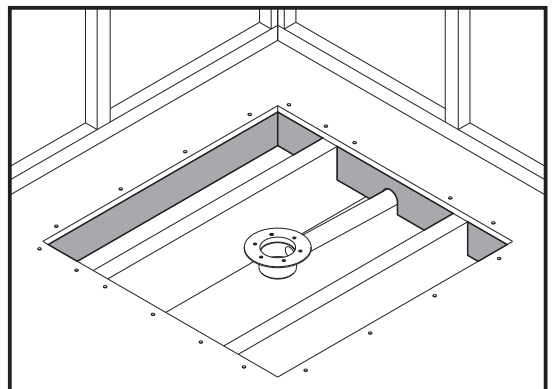

Screw fix 4" x 2" (100 x 50mm) timbers - *not supplied* - to underside of flooring to strengthen the edges of the cut-out.

Please ensure that these fixing screws will not interfere with the metal tray fixing screws fitted at stage 9.

6

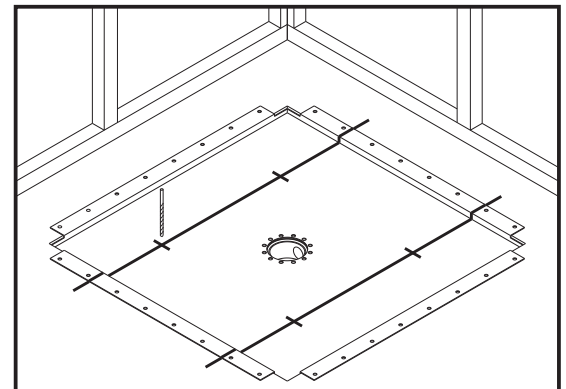

Mark centre lines of exposed joists onto flooring. Insert metal tray into cut-out and transfer drawn lines onto tray. Drill and countersink 2x holes per joist **through metal tray only** to suit your csk-head wood screws (*not supplied*), ensuring that the heads of the screws do not protrude above the tray surface when fitted.

7 CHECK POSITION OF METAL TRAY - It is important to carry out this DRY FIT stage at this point of the installation.

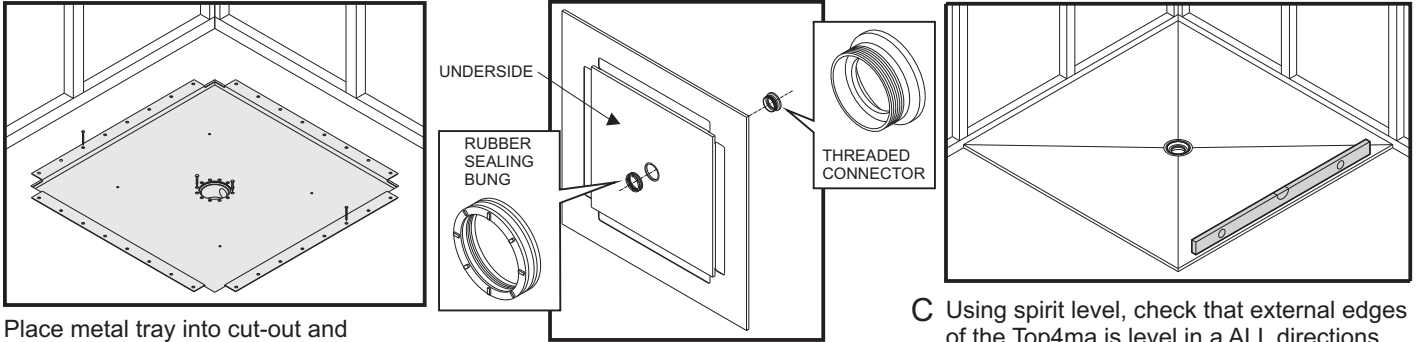

A Place metal tray into cut-out and secure using a couple of screws into the pre-drilled flange holes. Temporarily connect the waste to the tray using just two of the No.12x20mm long countersunk screws supplied with the waste (6 screws supplied in total).

B Refer to Waste instructions to fit the 'O' ring seal, Threaded Connector & Rubber Sealing Bung to Top4MA Collar. Position the Top4MA into metal tray to ensure waste and base fit correctly into position. If not, re-position metal tray as necessary to ensure correct fit.

C Using spirit level, check that external edges of the Top4ma is level in a ALL directions.

TIP Lightly lubricate the Rubber Sealing Bung to ease fitment and removal.

8 Lift out Top4MA using centre hole as grip - **do not remove by lifting out at the edges only, as this could cause damage to the Top4MA base.**

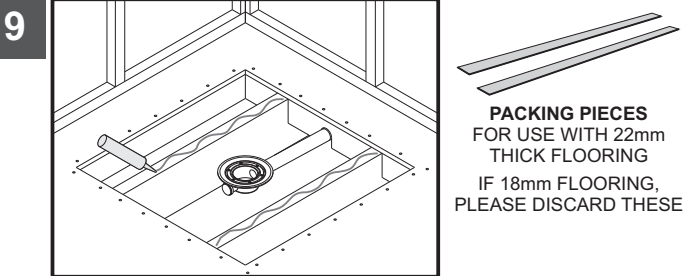

PACKING PIECES FOR USE WITH 22mm THICK FLOORING
IF 18mm FLOORING, PLEASE DISCARD THESE

Using **Kudos Grab Adhesive**, apply beads of adhesive to the top of each joist.

Fit metal tray into position and screw fix to joists and flooring through pre-drilled holes around the outer tray flanges using the no.12x20mm long countersunk head wood screws supplied.

TIP: Use pilot drill before inserting screws to prevent splitting the floorboard timbers.

NB- when fitting to 22mm flooring then the 2x packing pieces supplied with the metal tray must be fitted to the top of the joists.

Connect the waste to the tray using the six no.12 x 20mm long screws supplied with the waste.

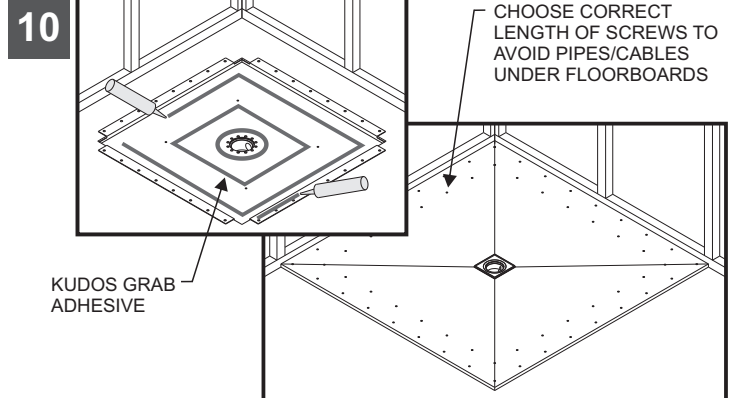

Apply beads of **Kudos Grab Adhesive** to base of metal tray and the 4 outer flanges as shown.

Carefully position Top4MA into position and stand on it to ensure it is fully bedded down onto tray and floor.

Secure in place by using drywall screws around the perimeter at 150mm centres ensuring these avoid the metal tray underneath.

NOTE: 900x900 & 900x800 Top4MA's require screw fixing in each corner only.

TIP Drive screws straight through Top4MA base, there is no need to drill pilot holes. Nails must not be used.

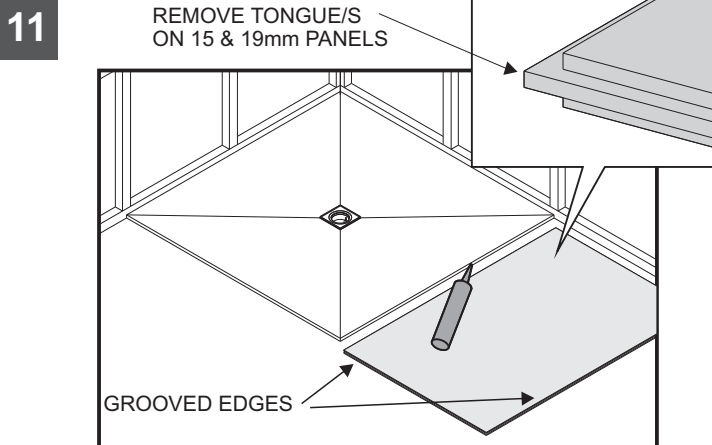

Using **Kudos Solvent Weld**, apply a continuous bead to the edge of the Top4MA, as shown.

Lay the first Floor4MA panel up to the edges of Top4MA and wall applying pressure to ensure the panel is fitted firmly against the Top4MA edge.

Secure the panel in place using drywall screws at 150mm centres, then wipe clean surplus Solvent Weld.

IMPORTANT

For 15mm & 19mm thick panels, tongue/s must be removed using sharp craft knife, wherever these butt up against the Top4MA and wall/s.

10mm thick panels are supplied square edged.

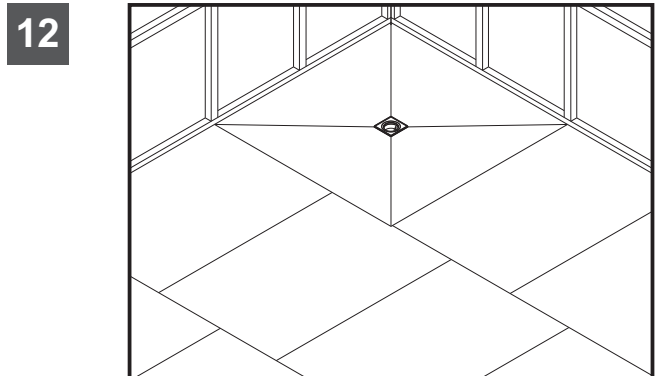

Continue to fit panels to adjoining panels using solvent weld on joints and screw fix to floor at 150mm centres.

The panels can be trimmed to size using handsaw, jigsaw or circular saw.

Joints should be staggered, as shown, to help strengthen the overall assembly.

Please use the tongue & grooved joints where applicable.

TIP Do not fully tighten the screws on the outer edge of the panel until the adjoining panel has been fitted - this will ease fitment of the tongue & grooved joints.

13

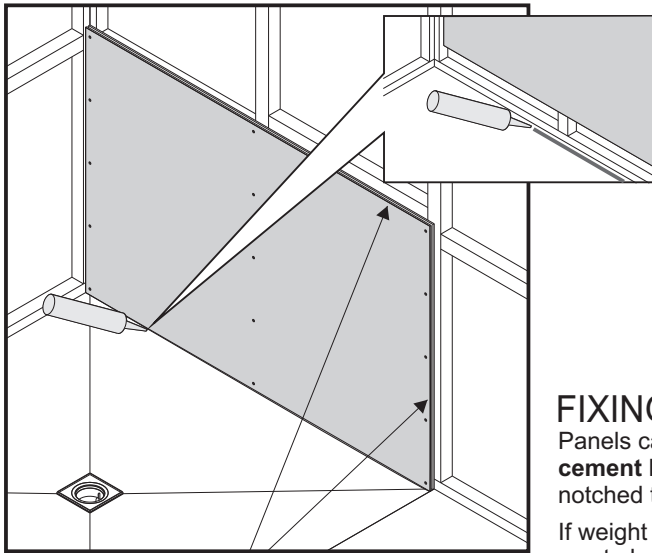

GROOVED EDGES

Using **Kudos Solvent Weld**, apply a **continuous** bead to the edge of the Top4MA, as shown on the inset diagram. Lay the first Floor4MA panel onto Top4MA and against the wall applying pressure to ensure the panel is fitted firmly against the Top4MA. Secure the panel in place using drywall screws at approx. 150mm centres into the stud-work, then wipe clean surplus Solvent Weld.

IMPORTANT Tongue/s must be removed from the panels using sharp craft knife, wherever these butt up against the Top4MA, floor panels and wall/s.



Do not fully tighten the screws on the outer edge of the panel until the adjoining panel has been fitted - this will ease fitment of the tongue & grooved joints.

FIXING PANELS TO SOLID WALLS

Panels can be fixed to solid walls, eg. brickwork or blockwork, by applying a **cement based flexible tile adhesive** to the back of the panels using a deep notched trowel, keeping the adhesive 50mm away from the edges of the panels.

If weight bearing fixtures are to be fitted to the walls, then the relevant panel/s must also be plugged and screwed in each corner and in the centre, to accommodate for this.

14

Continue to fit panels to adjoining panels using solvent weld on joints and screw fix to stud-work.

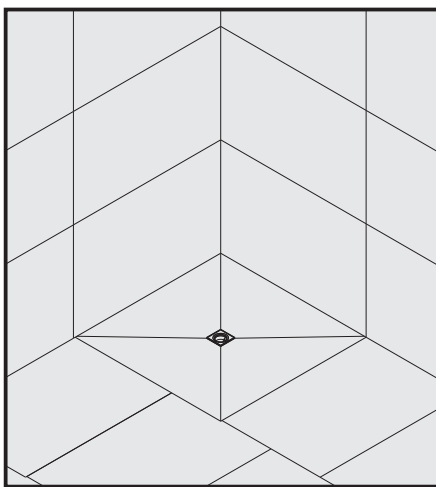

FULL INSTALLATION

Entire floor and all walls are covered using the appropriate Aqua4MA panels.

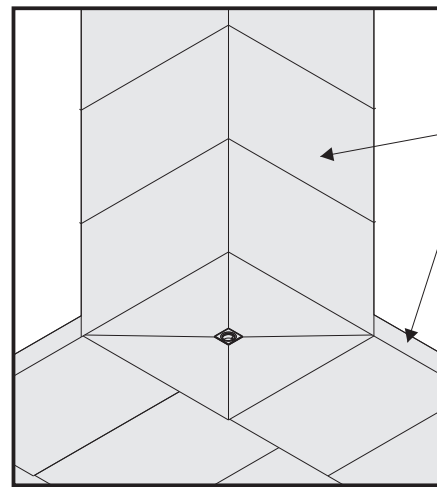

PART INSTALLATION

Entire floor plus walls within the shower area only are covered using the appropriate Aqua4MA panels. The remainder of the walls are fitted with the Aqua4MA skirting panels. We recommend this type of installation as the minimum requirement.

PLASTERBOARD / PLASTER REMOVED, THEN PANELS & SKIRTING FITTED FLUSH WITH EXISTING WALL

15 SKIRTING PANELS

Plasterboard/plaster to be removed and skirting panels fitted ensuring these are flush with the wall surface. Solvent weld all joints.

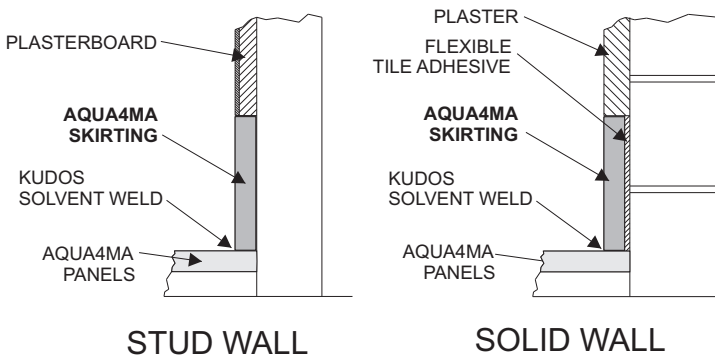

STUD WALL

SOLID WALL

16 HEIGHT REDUCERS

These are used to:

1. Reduce the height of the 15 & 19mm floor panel level eg. at doorways.
2. Increase the size of a standard Top4MA by adding to one or more edges.

Two types- 15 to 10mm reducer and 19 to 15mm reducer are joined and fixed like the floor panels.

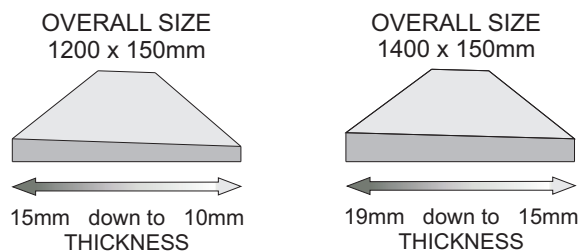

17

On completion, go over all joints with **Kudos Solvent Weld** to ensure these are totally filled.

Your Aqua4MA wetroom is now ready for tiling, using waterproof Flexible Cement-based Adhesive and Grout.

WRWAS WASTE for TILED FLOORING

Aqua4MA WETROOM SYSTEMS

KUDOS

Please read these instructions throughout before installing as incorrect fitting will invalidate the guarantee
These installation instructions must be used in conjunction with the Aqua4MA Installation Instructions

If you are unsure about these instructions please contact Kudos Shower Products:
Customer Service Helpline: 01539 564040

EXPLODED VIEW

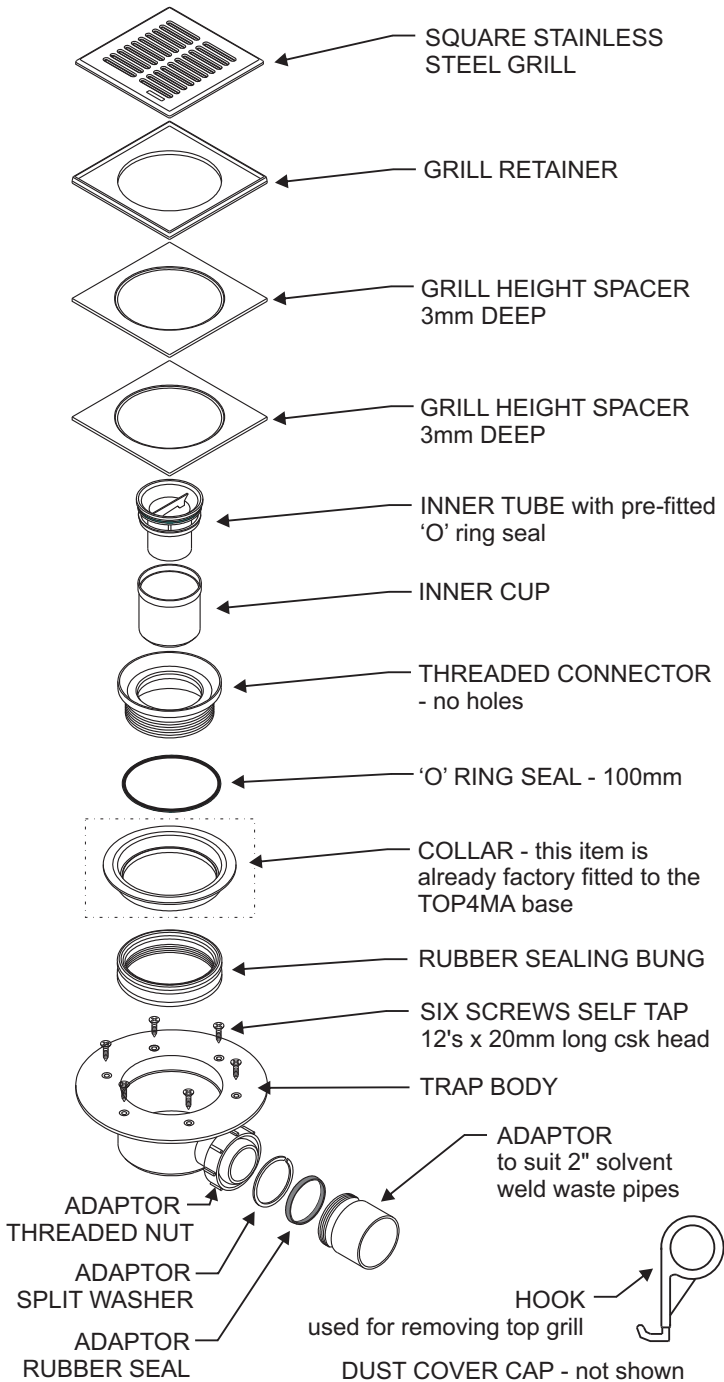

CLEANING

Clean on a regular basis to prevent dirt / debris build up. Use the hook supplied to remove the stainless steel grid, remove the Inner Tube & Inner Cup to clean and also clean inside of the Trap Body using warm soapy water only.

1 Fit 2" solvent weld waste pipe to the waste **Adaptor** using solvent weld - *not supplied*.
Do not use Solvent Weld for this or any other pipe joints.

2 The **Trap Body** is secured to the Metal Tray using the six no. 12's x 20mm long screws provided with the waste.

3 Insert '**O**' Ring Seal into **Collar** (pre-fitted into Top4MA base).

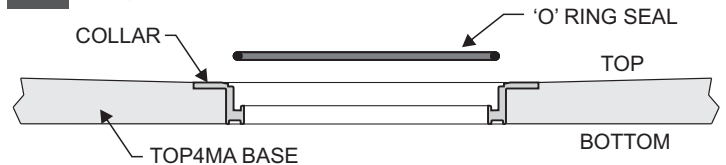

4 Insert **Threaded Connector** into **Collar**. Apply a continuous bead of silicone sealant (non acetoxic type) around the connector and underside of Top4MA base.

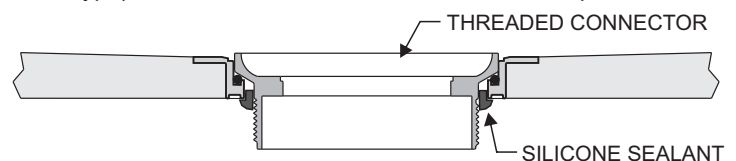

5 Screw **Rubber Sealing Bung** to the **Threaded Connector** and fully hand tighten, ensuring that the rubber seal is towards the underside of Top4MA base.

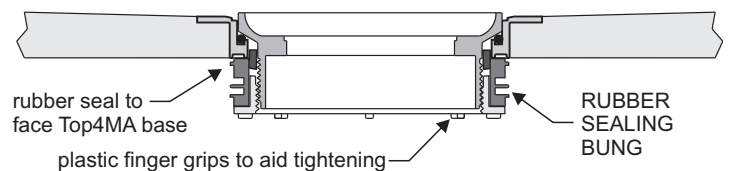

6 Fit Top4MA into Metal Tray as described in the Aqua4MA Installation Instructions. Connect **Inner Cup** to **Inner Tube** and insert into the waste. Fit **Dust Cover Cap** (not shown) into top of waste to prevent any debris from entering.

7 Before tiling the floor, remove **Dust Cover Cap** from waste. Check thickness of tiles + tile adhesive and adhere the **3mm Grill Height Spacer/s** if required then the **Grill Retainer** to the Top4MA base and each other, using **Kudos Solvent Weld** only, to ensure the top of the Grill Retainer is flush with top of tiles when fitted.
NB- These must be fitted SQUARE to the Top4MA base.

Part/s fitted	Overall Height
Grill Retainer only	7mm
Grill Retainer + 1x 3mm Grill Height Spacer	10mm
Grill Retainer + 2x 3mm Grill Height Spacers	13mm

Additional Grill Height Spacers can be fitted to suit your tile thickness.

IMPORTANT

The gap between the Grill Retainer and ceramic tiles must be filled with silicone sealant - **grout must not be used.**

WRWAS Waste Maximum Flow Rate = 37 litres/min.

WRWAV WASTE for VINYL FLOORING

Aqua4MA
WETROOM
SYSTEMS

KUDOS

Please read these instructions throughout before installing as incorrect fitting will invalidate the guarantee
These installation instructions must be used in conjunction with the Aqua4MA Installation Instructions

If you are unsure about these instructions please contact Kudos Shower Products:
Customer Service Helpline: 01539 564040

EXPLODED VIEW

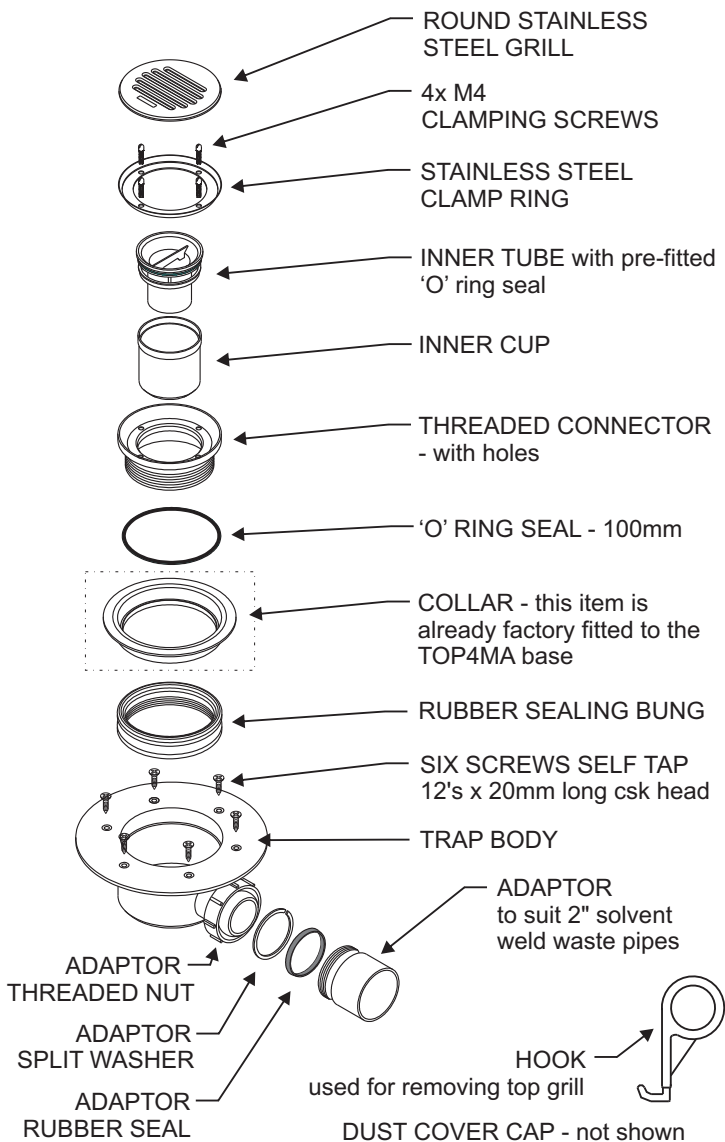

CLEANING

Clean on a regular basis to prevent dirt / debris build up. Use the hook supplied to remove the stainless steel grid, remove the Inner Tube & Inner Cup to clean and also clean inside of the Trap Body using **warm soapy water only**.

1 Fit 2" solvent weld waste pipe to the waste **Adaptor** using solvent weld - *not supplied*.
Do not use Kudos Solvent Weld for this or any other pipe joints.

2 The **Trap Body** is secured to the Metal Tray using the six no. 12's x 20mm long screws provided with the waste.

3 Insert '**O**' Ring Seal into **Collar** (pre-fitted into Top4MA base).

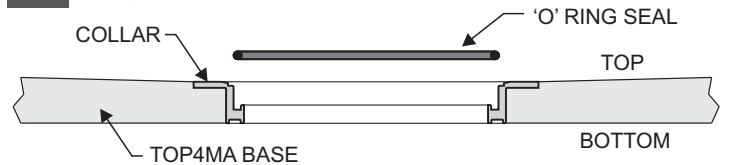

4 Insert **Threaded Connector** into **Collar**. Apply a continuous bead of silicone sealant (non acetoxic type) around the connector and underside of Top4MA base.

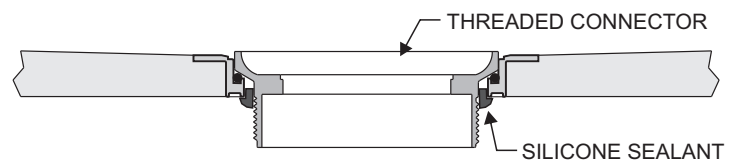

5 Screw **Rubber Sealing Bung** to the **Threaded Connector** and fully hand tighten, ensuring that the rubber seal is towards the underside of Top4MA base.

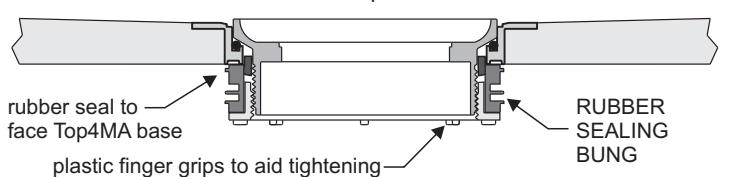

IMPORTANT- ensure the diagonally opposite holes in the **Threaded Connector** are parallel with the Top4MA edge, this will ensure that the slots in the grill top will align correctly when fitted.

Line drawn through centres of diagonally-opposite holes align parallel with Top4MA edge.

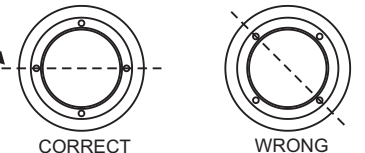

TIP Temporarily fit two M4 clamp screws into diagonally opposite holes, place a straight edge against the two screws to aid correct alignment with Top4MA outer edge.

6 Fit Top4MA into Metal Tray as described in the Aqua4MA Installation Instructions. Connect Inner Cup to Inner Tube and insert into the waste. Fit **Dust Cover Cap** (not shown) into top of waste to prevent any debris from entering.

7 Remove the **Dust Cover Cap** and mould the vinyl flooring into the well of the **Threaded Connector**, using a hot air gun, if necessary. Locate the holes and carefully cut holes in vinyl to allow fitment of the four M4 screws. Fit the **Clamp Ring** using the M4 screws and carefully trim the vinyl using the clamp ring inner diameter as a guide.

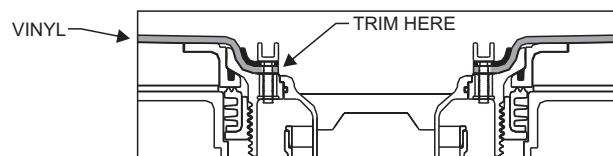

WRWAV Waste Maximum Flow Rate = 33 litres/min.